

SUNSAIL 52.4

Specifications and Equipment List - Sunsail Upgrades In Bold

DECK & HULL

- Design made following European Directive requirements and according to CE certification
- Vacuum infused hull (GRP / Sandwich balsa wood)
- Vacuum infused structural inner liner (Fabric - resin) bonded to the hull
- Injected deck construction in glass fiber and Saerform foam sandwich, covered with non-slip diamond pattern
- **Shallow cast iron keel fixed with bolts and stainless steel backing plates**
- Twin rudders affixed with stainless steel stock
- **White hull with Sunsail graphics**
- 8 Hull portholes
- 1 Open stainless steel pulpit
- 2 Stainless steel aft pushpits
- 2 Stainless steel handrails on coachroof
- 1 Ring lifebuoy bracket
- Welded ring on pushpit for flag
- Double life lines and stainless steel stanchions, 650 mm / 2'2" - **Side boarding gate on either side**
- Emergency ladder on pushpit
- Fully opening transom, convertible into swim platform (2,65 m x 0,80 m / 8'8" x 2'7")
- Intermediate cockpit access step
- Electrically operated swim platform
- Natural solid wood decking on swim platform
- **1 Stainless steel, fixed swim ladder**
- Sail locker with stainless steel ladder, shelving unit, lighting, and power outlet
- Sail locker accessed through deck hatch T70
- Self-draining chain locker - Clench bolt - Hatch cover
- Single roller stainless steel bow fitting with offset roller
- **Additional anchor arm with bobstay**
- 12V - 1500W vertical electric windlass - Remote control
- **Windlass control in cockpit with chain counter**
- 6 Aluminum mooring cleats - Stainless steel deck line protection
- **Bow stainless steel protection**
- **Remote control electric transom**
- **Transom protection**
- **Outboard engine bracket**

COCKPIT & COMPANIONWAY

- Self-draining cockpit
- 2 Watertight lockers under the cockpit benches
- 1 Locker in cockpit bottom
- 1 Gas compartment under port helmsman seat
- Natural solid wood slatted cockpit benches
- **Cockpit table with GRP leaves, wood center, USB socket and 12V socket**
- **Refrigerated ice box**
- **Cockpit cushions with seatbacks & 2 x Sunbed mattresses for companionway**
- Solid wood slatted helm seats with starboard storage locker
- Foldaway helmsman foot chock
- 2 Steering wheel consoles: Stainless steel steering wheels (900 mm diameter / 2'11") - Steering gear at the helm station - Steering line transmission system - Stainless steel handrail
- **Bimini & dodger**
- 1 Emergency tiller & 2 Deck accesses for emergency tiller
- 1 Steering compass on the cockpit table
- Engine throttle and control panel on starboard
- 1 Cockpit shower with mixer tap
- 2 Hinged PMMA companionway doors - Sliding hatch made of PMMA
- **Exterior cockpit door lock with padlock**
- Wooden saloon companionway with molded wood hanging steps with **non-slip surface**
- 2 Stainless steel companionway handrails
- 1 gas locker
- **LPG BBQ rail mounted**

MAST, RIGGING & SAILS

- **Classic 9/10 anodised aluminium mast, 2 spreaders**
- **Sails: Ullman charter spec with stack pack**
- **Self-tacking jib**
- **Profurl furler**
- Anodised aluminium boom
- Discontinuous stainless steel standing rigging
- Split backstay
- Rigid boom vang
- 2 Stand up mainsheet blocks on the coachroof
- 1 Self-tacking jib track with traveller
- All lines lead back to the helm stations (except boom topping lift and genoa halyard)
- Complete running rigging: main halyard, genoa halyard with mast-tie rail, boom topping lift with cleat on mast, mainsheet, 1 self-tacking jib sheet
- **Electric winch - port side - H46.2 STAEH**
- **Electric winch - starboard side - H46.2 STAEH**
- 6 Clutches
- Halyard covers
- 2 Flag halyards
- 1 Aluminum Speed Grip winch handle
- 2 Winch handle holders

SALOON/INTERIOR

- **Interior wood: Alpi brushed oak**
- **Silver macadamia upholstery cushions**
- **Dark grey paneling**
- Saloon Headroom: 6'8" / 2.03m
- U-shaped saloon bench - Double density foam
- 1 Flexible and swivelling reading light
- **Saloon table converts to double berth**
- Storage under bench seats
- Mirror on forward bulkhead
- Bottle rack behind the bench against the forward bulkhead
- 2 Panoramic coachroof windows with curtains
- 2 Hull portholes
- 2 Opening deck hatches with mosquito screen/blinds
- 1 Opening portlight with curtains in the coachroof side window
- **Blinds and mosquito screens on portlights**

GALLEY

- Galley Headroom: 6'4" / 1.94m
- U-shaped galley
- Counter-top in Clay compact with Corian fiddles
- 1 rectangular stainless steel sink - 1 Mixer tap with hot/cold water under pressure -- with **chopping board**
- 1 Gas stove 2 burners - Stainless steel oven on gimbal - Stainless steel protection handrail
- **Microwave oven**
- **Top loading and front loading fridge with accessible compressor and additional drawer fridge**
- Fitted cupboards and closed cubbyholes
- Bin with access on the counter-top
- 1 Lower unit: 3 Drawers
- 1 Hull porthole
- 1 Opening portlight with curtains in the coachroof side window

FORWARD HEADS

- Headroom: 6'1" / 1.85m
- Access from the cabin
- Shower area accessible by swivelling the washbasin, 2 Mirrors, Toilet accessories, 1 Opening portlight with curtains in the coachroof side window

FORWARD CABINS

- 1 Double bed (6'7" x 4'6" x 3'10' / 2m x 1.36m x 1.16m)
- 1 Hanging locker - 2 Closed high shelves, 1 Open shelving, 1 Drawer under the bed
- 2 Swivelling reading lights
- 1 Deck hatch with mosquito screen/blind
- 1 Hull porthole with sliding blind
- 1 USB socket
- Access door to the head

AFT HEADS

- Aft Heads Headroom: 6'1" / 1.85m
- Access from the saloon or the aft cabins
- Shower area accessible by swivelling the washbasin
- Toilet accessories
- 2 Mirrors
- 1 Opening portlight with curtains in the coachroof side window

AFT CABINS

- Headroom: 1,97 m / 6'6"
- Double bed (2,10 m x 1,60 m / 6'11" x 5'3")=
- 1 Drawer under the bed 1 Hanging locker - 1 Cupboard - Closed cubbyholes
- 1 Bed access sideboard
- 2 Flexible and multi-directional reading lights at headboard
- 1 USB socket
- 1 Hull porthole with sliding blind
- 1 Cockpit opening window with curtain under cockpit seats
- 1 Fixed cockpit window with curtain on the coaming

FOREPEAK CABIN

- **Access through deck hatch with stainless steel ladder**
- **Single bed, foam mattress, 2 storage lockers under bed, cupboard and shelves**
- **Electric toilet**
- **Sink - Mirror - Shower head mixer tap - Shower tray with curtain**
- **Power outlet, 1 LED ceiling light, 1 LED reading light**

ENGINE & CONTROLS

- Rotomolded freshwater tank 440L / 116us gal, under berth in forward cabin - 1 Deck filler
- Water-pressure system - Expansion tank - inline filter
- 40L / 11 US Gal Electric water heater (engine use)
- Electrical shower drain pumps
- 1 Electric bilge pump
- 1 Manual bilge pump
- 1 Electric pump for the ice box drain
- **Watermaker**
- **Electric flushing toilets throughout, including bow cabin**

ENGINE & CONTROLS

- **Yanmar 4JH110 CR 81Kw (110HP) Diesel**
- **Port and starboard helm stations**
- Engine throttle and control panel on starboard
- Engine compartment: Soundproofing foam - Ventilation: 3 air intakes and 1 forced air outlets 1 Alternator 12v / 125 Amp
- 1 Rotomolded diesel tank 200 L / 53 US Gal (under starboard aft berth) - Electronic gauge - Low level alarm - 1 Deck filler
- **Extra 200L / 53us gal fuel tank**
- Filters: Sea water - Diesel - Water separator
- Fixed three blade propeller
- 1 Engine access through companionway (opening with 2 gas pistons) - 2 Engine access through aft cabins
- **Bowthruster**

ELECTRICAL INSTALLATION

- 12 V Circuit
- 2 Service batteries (140 Amp) - 1 Engine battery (120 Amp)
- **AGM batteries & 40ah battery charger**
- 1 Load balancer
- 12 V Electrical panel (Fuses - Voltmeter - Water gauge - Fuel gauge - Battery warning - Fuel warning - Water warning)
- **110v outlets & USB in the cabins**
- 1 Shore power socket
- LED lighting: Overhead lights - Reading lights - Reading light, flexible and multi-directional
- LED navigation lights: 1 Masthead light - 1 Steaming light - 1 Mooring light on masthead
- **Indirect lighting**
- **Digital battery monitoring**
- **2 x 75w solar panels**
- **Inverter**
- **Generator**
- **Fans in cabins and saloon**
- **Fusion stereo + interior loudspeakers & waterproof exterior speakers**
- **TV**
- **WIFI enabled**
- **ZEUS 3, Autopilot, Wind & Depth, VHF with AIS**
- **Underwater light**
- **Air conditioning throughout including bow cabin**

SAFETY GEAR

- **Primary and secondary anchors**
- **6 x Fenders**
- **6 x Mooring / dock lines**
- **Lifejackets and safety harnesses per max pax**
- **Safe**
- **Bell**
- **Flare kit**
- **Binoculars**
- **Navigation tools: Parallel rule, compass, dividers**

CRUISING GEAR

- **Bed linens per max pax**
- **Plates, cups, saucers, glasses per max pax**
- **Flatware per max pax**
- **Pots, pans, miscellaneous food prep**
- **Cooking utensils**
- **Coffee pot, tea, kettle, toaster**
- **Snorkeling gear per max pax**
- **Towels and washcloths per max pax**

Length Overall: 15.94m/52ft 4in
Waterline Length: 14.52m/47ft 8in
Mast Height: 21.40m/70ft 3in
Beam: 4.80m/15ft 9in
Draft: 1.92m/6ft 4in
Displacement: 13930kg/30702lb
Fuel Capacity: 400L/106gal
Water Capacity: 440L/116al
Engine Yanmar 110hp

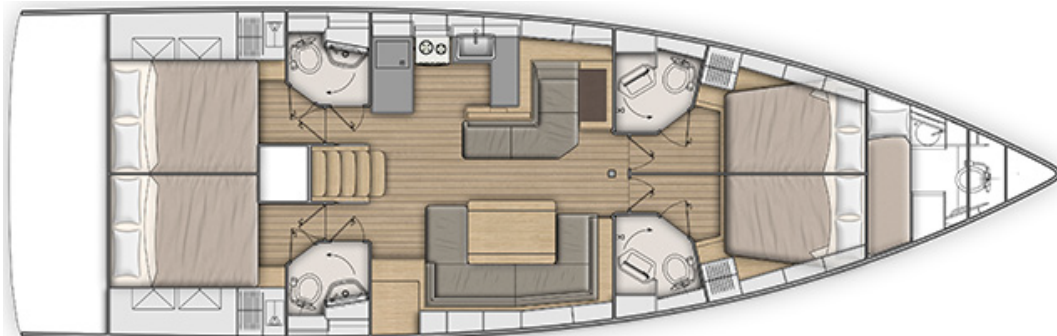

The Builder reserves the right to change or amend the contents of this document at any time without prior notification to any third party, and no liability will be accepted for errors contained within the same.