

Oceanis 40.1 NEW

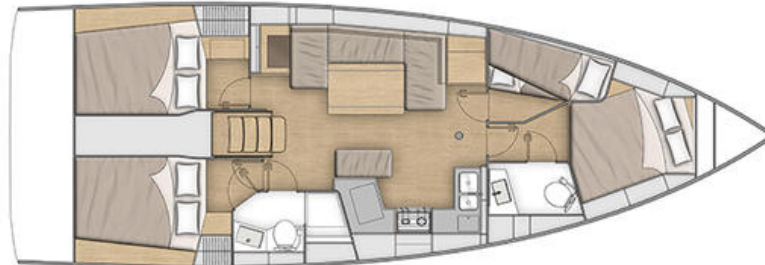

shipyard: **Beneteau**
launched: **2022**
length over all: **12.87 m**
length of the hull: **11.99 m**
width: **4.18 m**
draft: **1.68 m**
sailarea: **ca. 70 m²**

engine **45 HP**
fuel tank **lt.195**
drinking water tank: **lt.235**
berths: **8+2**
cabins **4**
salon: **convertible**
heads **2**
fridge / GPS plotter / log / eco; windmeter / boiler / 220v / outboard / automatic pilot

mainsail halfsticked with lazy jack and lazy bag
furling genoa

Navigation:

Compass – Wind station - Log - Echosounder - VHF - Binoculars - Clock - Barometer - Chart instruments – Italian Waters Pilot Handbook in English – Logbook – Bearing compass

Safety

Life raft - Safety harnesses – Life jackets – Horseshoe lifebuoy and light – Electric torch – Flare pack– smoke buoys - Electric and manual bilge pump – Foghorn - Extinguishers – First aid kit – Repair kit for engine, sails and tender– Wooden plugs - Radar reflector – Emergency tiller for wheel steering - Sheers — Halogen lamp – Diver down buoy & flag

Deck:

Electric windlass - Anchor with 70 m chain – Wheel – Gangway - Tender with rigid keel & two oars - Inflator – Small anchor with 15 m rope - Engine oil container– Bimini top – Sprayhood - Boathook - Fenders - Emergency anchor with 50 m rope – Winch handles - Rope (1X50m; 1x25m; 3x15m) – Bosun's chair - Bathing ladder – Water hose – Water, petrol, outboard fuel tank, - Gas bottles (Gas included) - Funnel - Bucket – Deck brush – Table – Outside shower - Work gloves - Cable 220V with battery charger – Cockpit cushion – Mask snorkeling and flippers – Cockpit speakers – Wind breaker jacket – Wind Scoop

Cabins/Galley:

Fridge - Hot water - Cooker with oven - Stereo - Pillows - Blankets – Bed linen – Towels - Cutlery - Glasses - Cups - Plates – Kitchen knives - Pots - Pans – 2 Italian espresso coffee makers – Coffee filters – Wooden spoons – Containers – Lemon squeezer - Grater – Tin opener – Bottle opener – Salad bowls – Thermos flask – Tablecloth – Cabin & dining area fan - **Shore power air conditioning**